

ADVANCED SIDE HANDLE

TILTING

ARM YOUR CAMERA

POWER SUPPLY SIDE HANDLE

Powered by
F570/F550 battery

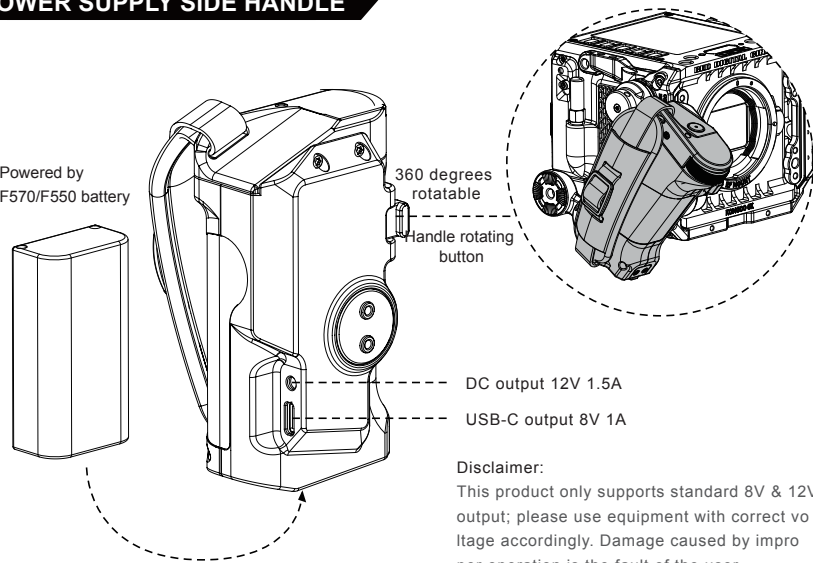

SIDE RECORDING HANDLE

Powered by
F570/F550 battery

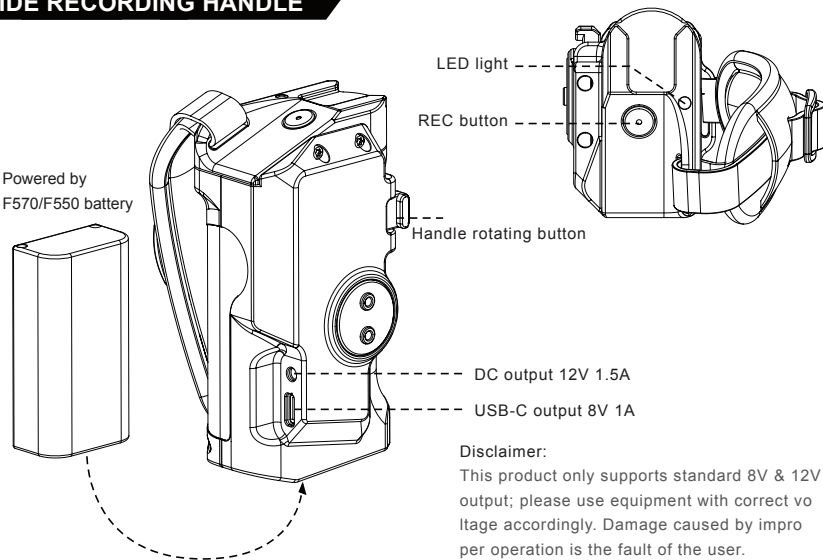

POWER SUPPLY RECORDING SIDE HANDLE

Powered by
F570/F550 battery

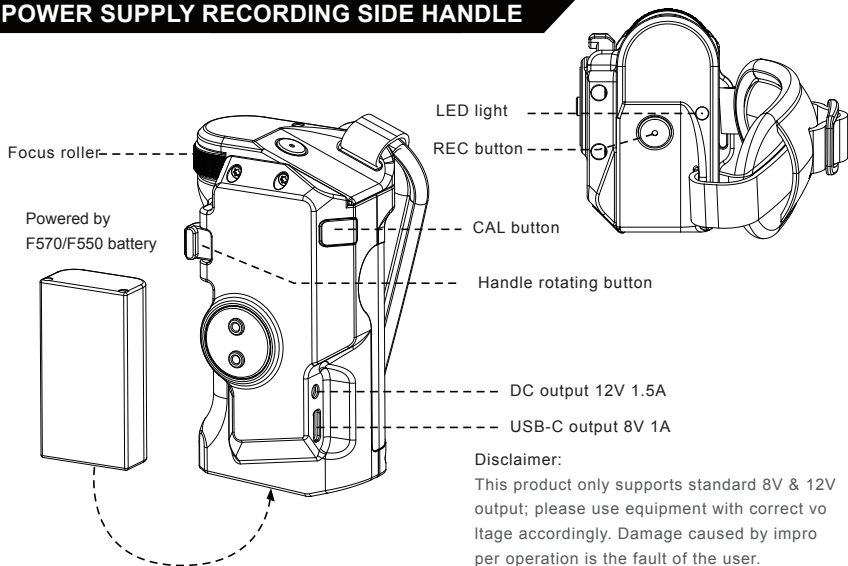

WOODEN SIDE HANDLE

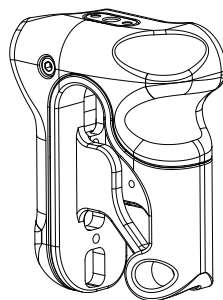

Separate cold shoe attachment allows you to mount microphone, wireless video transmitter, hard drive, monitor, mini lights, etc.

INSTRUCTIONS

1 Power on/off

To power on the handle, hold REC button for 3 secs until the LED light turns green
To power off the handle, hold REC button for 3 secs until the LED light turned off.

2 Record function

To power the motor, connect the handle the Nucleus Nano motor via the USB-C to Micro USB cable.

To set up the record start/stop function, connect your camera's specific R/S cable from the camera to the Nucleus Nano motor. Click the REC once to start recording; the LED light will turn red. Click the REC button again to stop recording; the LED light will turn green.

3 Automatic calibration

Settings for infinite range lens

Turn the lens manually to its minimum value, and tightly attach the Nucleus Nano motor to the gear ring, then double click CAL button. When you see "CALING" on the motor OLED screen, turn the handwheel to reach the maximum value of the lens, then double click CAL button. Wait for the motor to read the range status of the lens, then the calibration will be complete.

Settings for limited range lens

Attach Nucleus Nano motor to the gear ring tightly, press and hold CAL button till you see "CALING" on the motor OLED screen. Wait for the motor to read the range status of the lens, LED light will stay green during auto calibration.

AB stoppers function

Attach Nucleus Nano motor to the lens gear ring tightly, then press and hold the CAL button until the motor finishes reading the lens range. Turn the handwheel to point A and click the CAL button; the LED light will turn green. Then turn the handwheel to point B and click the CAL button again; the LED light will then turn blue. The calibration is complete.

4 Follow focus handwheel calibration

Press and hold the REC button then double click the CAL button until the LED light turns blue, Turn the handwheel clockwise to the end, then double click the CAL button, The LED light will flash blue. Turn the handwheel counterclockwise to the end, the LED light will turn green, The calibration is complete.

You may need to calibrate the handwheel in the following circumstances:

- (1) Motor spins backwards when controlled by the side handle.
- (2) Motor cannot reach the minimum or maximum value of the lens after auto calibration is finished.

5 DC OUT/TYPE C USB power outputs

Customized power cables are available. For example: a cable is available that can power BMPCC 4K for 3-4hrs.

6 Low power alert function

The LED light will start flashing in green when the battery is less than 20%.

7 Firmware upgrade

You may download the firmware upgrade files from www.tilta.com. Please feel free to contact our sales team for any inquiries.

ADAPTORS

6 different advanced side handle attachments can fit all kinds of needs.

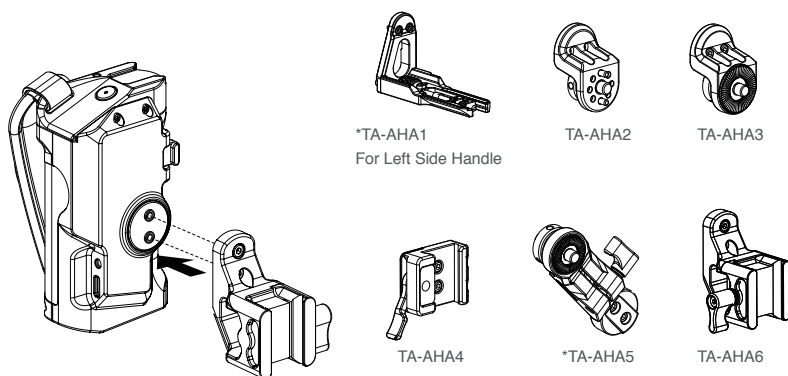

*Please Note: Attachment AHA1 and Attachment AHA5 are not compatible with Side Wood Handle